

East Greenland and the Spectacular Scoresby Sund

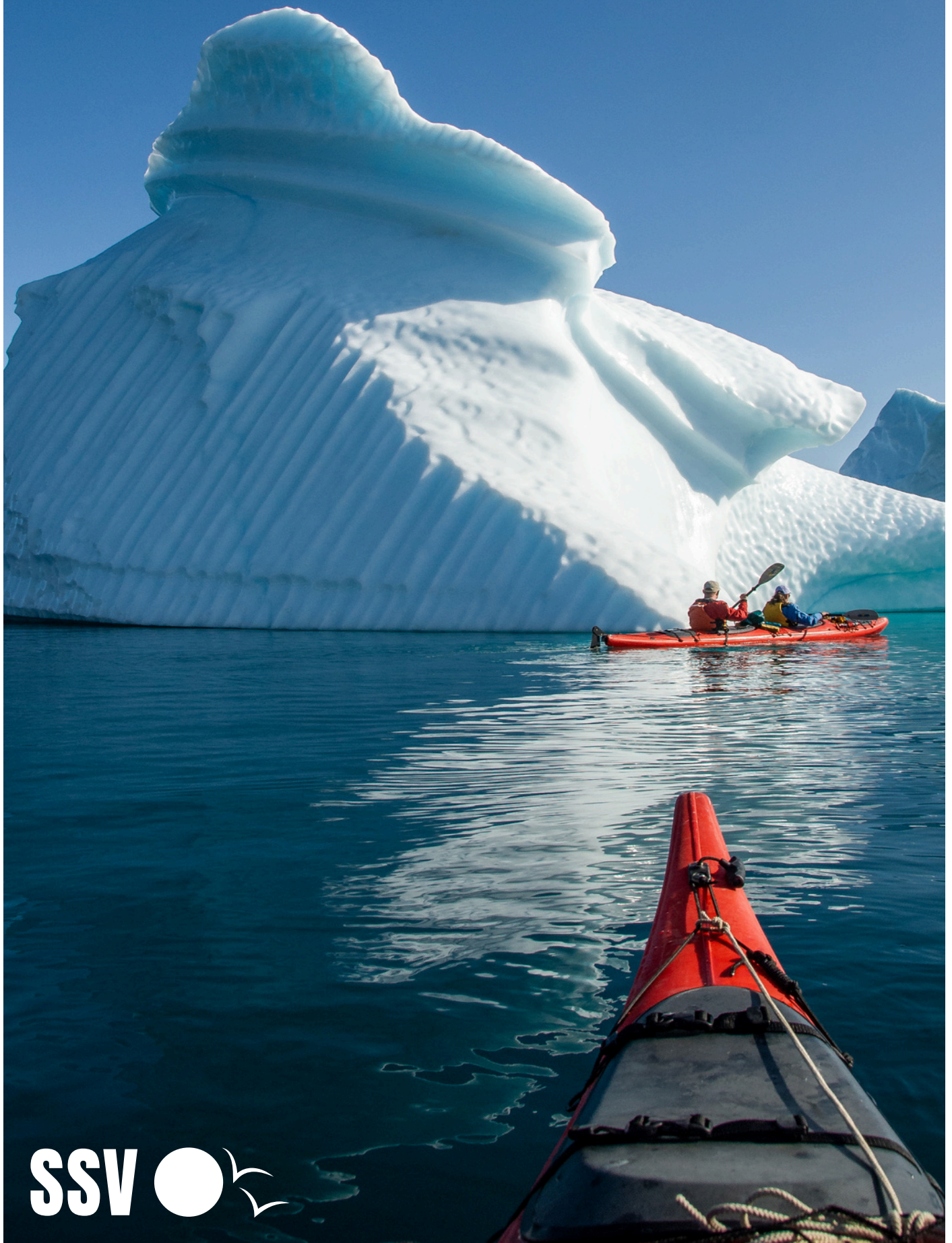



The World By Kayak



The Trip

Southern Sea Ventures (SSV) are polar sea kayaking experts, being the first company to operate commercial sea kayaking trips in the Antarctic, followed closely by expeditions in the Arctic. Since this time, experiencing the polar regions by expedition vessel has been a passion that we have shared with many of our like-minded adventurers. Joining SSV ensures safety, expertise and adventure with like minded travellers on your journey to the Polar regions.

We are excited to announce that in 2026 we are heading to remote East Greenland and the spectacular Scoresby Sund (Kangertittivaq in Greenlandic). Our vessel of choice for this amazing Arctic adventure is *M/S Quest*, a 50-passenger expedition ship. A small vessel of this size allows for an intimate travel experience compared to larger cruise vessels and is ideally suited to small groups of paddlers, hikers and those who enjoy a boutique cruise experience. Our Arctic voyage begins in the scenic settlement of Ísafjörður, located in the Westfjords region of northwest Iceland. After embarking *M/S Quest*, we head north, crossing the Denmark Strait to Scoresby Sund, located in East Greenland and high above the Arctic Circle. Scoresby Sund is the longest fjord on the planet, stretching around 350km inland from the Greenland Sea.

The area is a nature lover's paradise, with breathtaking scenery of towering cliffs, colossal icebergs, glaciers and pristine Arctic wilderness. The fjord's serene and untouched landscapes are a privilege to explore and offer endless opportunities for photography, wildlife viewing, paddling, hiking and cruising. With the summer waning and the midnight sun disappearing, a late August departure can be an excellent time to witness the Northern Lights dancing across the sky, with East Greenland one of the finest locations to witness the spectacular natural phenomena. The kayak, qajaq in Inuit, was designed for hunting some 4,000 years ago and has been an integral part of the history and culture for the Inuit of Greenland, where many believe the first kayak was constructed.

We will celebrate the past generations of Inuit paddlers as we trace their wake in this most amazing environment. Join SSV on this special departure aboard the *M/S Quest* and experience Greenland's breathtaking landscapes, wildlife encounters and incredible paddling and hiking adventures.

Trip Details

Dates: 25 Aug-5 Sep 2026

Length: 12 days

Destination: Greenland

Vessel: *M/S Quest*

Start/Finish: Ísafjörður, Iceland

Trip Price: (See Deck Plan on Pg 8, costs per person)



TRIP HIGHLIGHTS

- The world's largest fjord system (Scoresby Sund).
- Paddle in the home of the sea kayak or join active hikes in untracked terrain.
- Historic sites & Inuit culture.
- Wildlife opportunities - polar bears, Arctic fox, reindeer, musk ox, Arctic hare, seals, whales and thousands of sea birds.
- Active glaciers and towering icebergs.
- Opportunities to see the northern lights above the Arctic Circle.
- Add an adventure pre or post cruise in the unique landscape of Iceland and experience rumbling volcanoes, rugged lava fields, hot springs and cascading waterfalls.

ITINERARY AT A GLANCE

25 Aug: Meet in Ísafjörður, north west Iceland.

26 Aug: Embark *MS Quest* in the afternoon.

27 Aug: Crossing Denmark Strait to Greenland.

28 Aug - 3 Sep: Exploring Scoresby Sund and the east-coast of Greenland.

4 Sep: Crossing Denmark Strait to Iceland.

5 Sep: Disembark in Ísafjörður. Trip concludes.

MEETING PLACE AND TIME

We meet in Ísafjörður, Iceland, on 25 August. It is recommended to arrive into Iceland a day or two before the trip start date, in case of flight delays and to recover from any jet lag. Iceland is a fantastic travel destination, rewarding travellers with spectacular sightseeing and experiences. See Iceland's tourism website for inspiration and information: <https://www.visiticeland.com/>

HOW TO GET THERE

Many international airlines fly into Iceland's capital, Reykjavik. Icelandair fly between Reykjavik and Ísafjörður with a flight time of 45 minutes. See Icelandair's website below for flight details. An alternative to flying is to rent a car for a self-drive holiday pre or post voyage. The driving distance between Reykjavik and Ísafjörður is 450km (280 miles) on sealed roads. Flights to and from Iceland can be busy in August and early September and we recommend you book once we let you know the trip is a guaranteed departure to ensure the best timings, connections and cost. It is highly recommended to book changeable tickets.

<https://www.icelandair.com>

ABOUT OUR POLAR KAYAKING PROGRAM

For those joining our kayaking program, we intend to use the ship as a comfortable floating base camp, paddling at every opportunity and returning for the comfort of meals and our cosy cabins. Zodiacs will be available for extended shore excursions for those who do not wish to paddle on any given day. We hope to paddle one to two times a day, with most paddles ranging from two and a half to four hours combined with some shore landings. Landing ashore by kayak, we can stretch our legs and enjoy walks on the lush tundra among late summer flowers and experience other shore based highlights. The flexibility of kayaking with a small private group ensures our own unique experiences, the quiet dip of your paddle perfectly suited to our awe-inspiring surroundings. Your kayak surcharge covers use of a drysuit, all your paddling and kayak equipment and the services of a professional sea kayak guide.

GENERAL INFORMATION ABOUT OUR SEA KAYAKING PROGRAM

Our kayaking trips cater to both frequent paddlers and those new to the sport, and we take pride in introducing people to the joy of paddling. Sea kayaking is an activity that anyone with a moderate level of fitness can enjoy, and it's often compared to brisk walking or cycling. While previous kayaking experience isn't necessary, it is important to have a sound level of fitness and, most importantly, a sense of adventure. The degree of difficulty on any trip will depend on weather conditions, so flexibility and a positive attitude are key. We ask that all participants are comfortable being in the water for safety reasons and highly recommend you have practiced a wet exit prior to your trip. Most trips are designed for individuals with a moderate level of fitness and an adventurous spirit. To ensure the highest safety and to maximise the experience of the group as a whole, we primarily use double kayaks. Single kayaks are offered on request, subject to approval and demonstration of experience appropriate to the trip. The use of single kayaks and the overall configuration of the group is at the discretion of the guide. Depending on the needs of the group, we will offer differentiated itineraries, with extra paddling opportunities for those who want more time on the water and more relaxed outings for those who prefer shorter paddles. With SSV's expert guidance, quality equipment and a flexible, fun approach, our kayaking trips are designed to offer an unforgettable experience for all levels of paddlers.

If you have any questions about whether a trip suits your fitness level, don't hesitate to contact us—we're happy to discuss your ability and help you prepare for your trip and to choose the right adventure.

Photography Package Add-on

With its towering granite peaks, shimmering fjords, drifting icebergs, and vibrant Inuit settlements, East Greenland offers an otherworldly canvas for photographers. For those wanting to elevate their creative vision, join celebrated landscape photographer Sapna Reddy on our optional Photography Package. Sapna brings a rare blend of artistic depth and technical expertise, helping you craft compelling images in one of the planet's most visually striking and remote regions. The package includes a pre-departure equipment consult, in-field instruction tailored to Greenland's dramatic environment, and exclusive access to a dedicated photographers' Zodiac—giving you the best possible vantage points to capture light, land, and life in the Arctic.



ITINERARY

The following itinerary should be seen as an approximate guide only. This is an expedition voyage and our itinerary largely depends on weather, calving activity and amounts of ice. Our program may also change to take advantage of opportunities as they arise, to suit local conditions and according to the preferences of the group.

25 Aug: ARRIVE ISAFJÖRÐUR (ICELAND)

We meet in Ísafjörður, in Iceland's north-west. If flying in today, you will be transferred to the group hotel. The rest of the day is at your own leisure until a group dinner with your guides this evening. If you are in Ísafjörður prior to this day, make your way to the group hotel (if not already staying there), room check in is from 3pm. Ísafjörður has plenty to see and do, including the Westfjords Heritage Museum and the Museum of Everyday Life. There are great gift shops, including knitwear stores selling traditional Icelandic designs. For some action, there are scenic walks and mountain bike trails around the town. Day trips to Hornstrandir Nature Reserve and Vigur Island, home to an incredible number of Arctic terns and coastal birds, including puffins, are possible from Ísafjörður. Meet your guides tonight for a welcome dinner. **D/ Overnight hotel.**

26 Aug: EMBARK *M/S Quest*

The morning is at your own leisure before the afternoon transfer to *M/S Quest*. On boarding, you'll meet the captain and crew who will introduce you to life onboard and conduct a safety briefing. Your kayak guide will cover paddle safety and help with gear fitting. We depart Ísafjörður and head out to the mouth of the fjord, called Ísafjarðardjúp which translates as 'Depth of the fjord of sea ice'. Please note that lunch is not included today. **B • D/ *M/S Quest***

27 Aug : CROSSING THE DENMARK STRAIT

We will be at sea all day, cruising across Denmark Strait towards Greenland. A favourite pastime is to spend time on the outer decks looking out for whales, dolphins, seabirds and icebergs! Otherwise, the inside panorama deck is perfect for sheltered views and a hot beverage. One big advantage of a late Aug/early Sep voyage is the drawing in of night after the summer months of midnight sun, meaning a chance to view Northern Lights, with few places offering such good prospects as Greenland. **B • L • D/ *M/S Quest***

28 Aug - 3 Sep: EXPLORING EAST GREENLAND & SCORESBY SUND

Our aim for the next week is to experience as much time as possible outdoors, be it paddling, hiking or wildlife viewing (or all three!) Our experienced Arctic team will use their know-how to design a day-to-day itinerary that makes the best use of the weather, ice conditions and wildlife opportunities. Just north of Scoresby Sund is the Northeast Greenland National Park. Founded in 1974, Northeast Greenland NP is the world's largest national park and the ninth largest protected area on earth, covering 971,245 square kilometres (375,000 square miles). Most of the park is covered by the Greenland Ice Sheet, which is the largest ice sheet in the northern hemisphere and globally second in size to the ice mass that covers Antarctica. Northeast Greenland NP is uninhabited by humankind, except crew at four weather stations and the Sirius Dog Sled Patrol. In the summer, there may be visits from scientists and researchers in connection with biological or geological expeditions as well as Arctic trip expeditions, such as ours. Only the coastal areas of the NP are ice-free during the summer months. Depending on conditions, we may venture into the NP coastal areas. Scoresby Sund, Kangertittivaq in Greenlandic, stretches almost 350 kms from east to west. Numerous fjords radiate from the sound, with the longest being 200kms (125 miles) and extending to the edge of the inland ice cap. Scoresby Sund is one of the birthplaces of Greenland's famous giant icebergs and among the most scenic and spectacular landscapes in the world. With its' tree-like structure, the main body of water is approximately 110 km (68 miles) long, branching into a system of fjords covering an area of about 38,000 km² (23,000 miles). **B • L • D/ *M/S Quest***

Trip Notes - Greenland Expedition

Following are locations we'll potentially visit.

SYDKAP

A small promontory jutting out from Scoresby Land offering good walking and delightful views across the sound. There are great opportunities for kayaking past lonely beaches where 3000-year-old gravesites can be visited on shore. Nests of grounded giant bergs the size of 10 storey buildings with green tunnels and aquamarine lakes offer hours of endless enjoyment for kayakers and zodiac riders.

ITTOQQORTOORMIIT

Ittoqqortoormiit is Scoresby Sund's colourful Inuit community of approximately 350 people. The town is situated close to the world's largest national park and right next to the world's largest and deepest multi-branched fjord system. Hunting is a significant cultural and economical factor for the community, although tourism is growing in importance. We'll explore the village and meet parents pushing prams with cute round-faced babies peeping out from Arctic fox fur jackets. Listen to the crescendo of howling emerging from lines of huskies secured to chains or sit spellbound in the beautiful Lutheran Church serenaded by the local organist. Meeting the locals in this far-flung settlement is a highlight for many.

BJORNE ISLANDS

Bjorne Islands or Nannut Qeqertaat, meaning 'Bear Islands', provide incredible opportunities to wind through the narrow passages between towering icebergs by kayak and zodiac. For walkers and hikers, step ashore to explore the coastline or hike to the hill tops to view the icecap in the distance.

ALPEFJORD

Alpefjord is a narrow waterway situated between serrated brown mountains of up to 2200 metres (7000 foot) and hanging glaciers clinging like limpets to stony gullies. The snout of the Sefstrom Glacier juts out and almost blocks Alpefjord, however, there's access for kayaks and zodiacs, with the opportunity to walk on the glacier. Clumps of Arctic flora in its late summer glory may still be visible as we cruise along the coast.

RED FJORD

This Fjord system is located in the interior of Scoresby Sund. The contrast of red sandstone cliffs against white and blue icebergs makes Red Fjord a photographer's paradise. We may be able to land on the shore for a tundra walk and an opportunity to see musk oxen grazing.



4 Sep: DEPARTING EAST GREENLAND – AT SEA

We depart East Greenland and head south into the Denmark Strait. On the crossing to Iceland, we'll look to the skies to spot a variety of seabirds, including Ivory Gulls and migratory Brunnichs Guillemots. This evening may be the last opportunity to experience the Northern Lights while on board. **B • L • D/ M/S Quest**

5 Sep: DISEMBARK ISAFJÖRÐUR, ICELAND

The expedition concludes in Ísafjörður this morning. You may choose to continue exploring Iceland by land or catch a flight to your next destination. End of trip arrangements. **B/END OF TRIP ARRANGEMENTS**

THE SHIP

M/S Quest was built in Denmark in 1992 to serve as a ferry along the west coast of Greenland. In 2004/5, it was completely refurbished into a comfortable expedition ship and in 2018, the passenger areas underwent further renovation. *M/S Quest* can accommodate 50 passengers, with all 24 cabins being outside cabins equipped with private facilities. In the dining room, guests enjoy delicious meals between landings, while the panorama lounge offers breathtaking views of the surrounding landscape. This lounge serves as the venue for entertaining talks about the area's flora, fauna and history. It also features a bar and a small library. The ship boasts spacious observation decks to enjoy the stunning vistas and the bridge welcomes you around the clock. You are welcomed by an international crew, with the atmosphere on board relaxed and very friendly. There are five Zodiacs and five guides on *M/S Quest*, along with additional SSV kayak guides.

CABINS

Each cabin has a private toilet and shower with shampoo, shower gel, soap and hairdryer, a fitted wardrobe with hangers, a mirror, desk and chair and a small safe. Your cabin will be cleaned daily with new towels available upon request. The triple cabins feature upper and lower berths, while all other cabins have either two lower berths or a double bed. The superior cabins are spacious and the owner's cabin offers a double bed, two large picture windows and a separate seating area. The electrical outlets in your cabins and elsewhere on the ship are 220 volts with Scandinavian two-prong plugs. We recommend you bring an international adapter if you have devices that need to charge. All cabins are also equipped with USB-A outlets for charging of smartphones and cameras.



Cabin Pricing (USD).

Triple cabins	(upper/lower beds)	purple	\$9,990
Twin cabins	(twin beds)	blue & yellow	\$11,990
Twin Plus	(twin beds)	blue & yellow	\$12,490
Double cabins	(double bed)	orange	\$12,890
Superior cabins	(large double bed)	pink	\$13,390
Owner's cabin	(large double bed)	green	\$14,590

Optional activity supplements (USD).

Kayaking Activity: USD \$1250 per person

Photography package: USD \$1000 per-person.

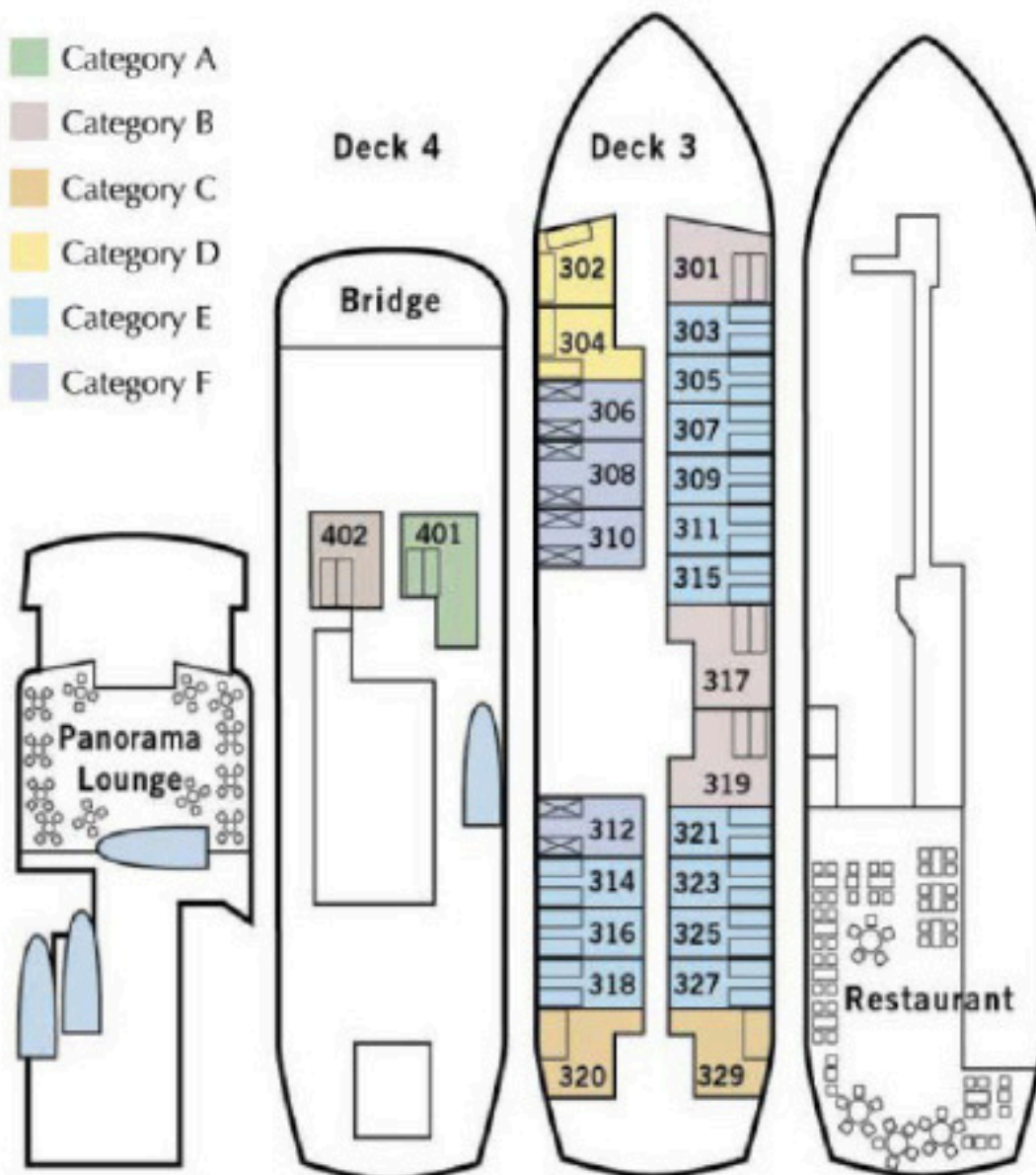

CLIMATE

Greenland experiences very mixed weather, sometimes all in one day! Be prepared from everything from calm, mild and sunny days to freezing temperatures and horizontal rain and fog. On the east coast of Greenland, Ittoqqortoormiit features bitterly cold winters, chilly summers and no monthly average close to the 10°C (50°F) threshold that would allow tree growth. This coupled with an average annual temperature of -5.0°C (23°F) makes Ittoqqortoormiit one of the coldest permanently inhabited locations on Earth. In late Aug and early Sep, expect a minimum average of -1°C (30°F) and a maximum of 4°C (39°F). Prepare for sunshine as well as showers. Wind is generally light to moderate but can shift quickly. Water temperature at this time of the year is around 2°C (35 °F). Our start and finish point for the trip is Isafjordur, in north-west Iceland. Ísafjörður can experience high winds and very few clear days throughout the year. However, it's slightly warmer, compared to East Greenland, with the average temperatures in late Aug and early Sep ranging from a low of 5°C (41°F) to a high of 10°C (50 °F). Expect 11 hours of daylight during the trip.

MEALS

All meals on board *M/S Quest* are included in your voyage cost and are of a very high standard. A buffet is served for breakfast and lunch, while dinner is served at the table. We are happy to cater for vegetarians and other special dietary requirements. Please let us know your dietary requirements at the time of booking. Alcohol and soft drinks are not included in your voyage cost.

EXPEDITION STAFF

There will be up to seven SSV dedicated expedition staff onboard the vessel in addition to *M/S Quest* crew and hospitality staff. All our expedition team members are experts in Arctic travel.

THE LAND, HISTORY AND CULTURE OF GREENLAND

Located in the North Atlantic Ocean, Greenland is the world's largest island. Two-thirds of Greenland lies above the Arctic Circle, and as a result, there is almost 24 hours of sunlight in the short summer and complete darkness in mid-winter. Nearly half of Greenland is protected by the National Park of Greenland, the world's largest national park at 971,245 square kilometres. The Greenland Ice Sheet covers about 80 percent of the island, second in size only to the ice mass that covers Antarctica. The first people to set foot in Greenland arrived around 4000 to 5000 years ago. Coming from the North American continent, via Canada, they travelled when the sea froze in the narrow strait at Thule, in northern Greenland. Greenland's population today is descended from the last immigration, the Thule culture, which arrived around the 9th century AD. In 1979 Greenland was granted home rule by the Danish and in 2009 Kalaallisut was made the official language of Greenland. Today, Greenland is an autonomous territory in the Kingdom of Denmark. The official name of Greenland is Kalaallit Nunaat. In 2020, the population of Greenland was 56,000 with Nuuk, the capital, numbering 15,000 residents. The main industry in Greenland is fishing, the island is also very rich in minerals. Greenlandic culture is influenced by Inuit traditions, with hunting and fishing remaining a way of life on the island. Many Greenlanders still use traditional tools and hunting methods, such as the qajaq (sea kayak) and ulo (a curved knife used to carve seal meat).

PLANT AND WILDLIFE IN EAST GREENLAND

Greenland is mostly tundra, with the flora composed of mosses, lichens and small shrubs. One notable shrub is the dwarf willow, the northernmost woody plant. Other plants include the bog bilberry, lingonberry and crowberry, all of which are used in local cuisines. Although most of Greenland is tundra, one valley at the very southern tip of the island, Qinnua Valley, is a subarctic natural forest, with downy birch and grey-leaf willow trees growing 7-8 metres tall. This is the only forest present in Greenland, and a protected natural area. Despite the cold temperatures, Greenland possesses a great variety of wildlife, both in the surrounding waters and on the coastal lands away from the Greenland Ice Sheet. Many species of fish live in nutrient-rich waters around Greenland, including highly economically significant cod and halibut. Around two million seals are believed to inhabit Greenland's waters, including the ringed, harp and common seals. Many types of whale visit Greenland in the summer and autumn, with visitors of the beluga, blue, Greenland, fin, humpback, minke, pilot, sperm and right whale species. Walruses are also common in the northeast of the island and if we are really lucky, we may glimpse the elusive narwhal! Greenland also supports a population of warm-blooded land mammals, such as the small Greenland Arctic hare, northern collared lemming, muskox and the Greenland Arctic fox. A large number of birds make their home on Greenland's coasts, many of which are water birds, including species of sea duck, cormorant, puffin, gull and sea eagle. However, some bird species are primarily terrestrial, including the small 15cm snow bunting, the widespread rock ptarmigan, large snowy owl and white-plumed gyrfalcon. While it is rare to see a polar bear in Scoresby Sund, they do live throughout the east coast of Greenland and can be spotted roaming the shores or swimming across fjords. We are always polar bear aware and take measures to stay away from these beautiful animals, viewing them from a safe distance if spotted. All guides carry rifles and flare guns as a precaution while on outings. Due to Greenland's sheer size and that hunting still takes place, wildlife sightings are never guaranteed.

COMMUNICATION

The ship can be contacted via satellite phone. Closer to departure, guests will receive final documents which includes contact information. It's possible to buy vouchers to use the ship's internet during your trip, details will be provided onboard. Please note that you will not have reception on your mobile phone during most parts of the expedition.

CONSERVATION

It has always been our motto that "we take only photographs and leave only footprints". We are keenly aware of the ecology of the areas we visit and try to limit our impact on them. We ask that each person takes out everything they bring in including sweet wrappers, batteries and all plastics.

TRAVEL INSURANCE

Travel insurance is a requirement for participation on this trip. Please ensure your policy covers loss of monies if you need to cancel due to illness or accident, prior to and during your trip. Your policy should also cover overseas medical expenses (including due to Covid-19), loss of baggage and personal items, trip cancellation due to weather and overseas emergency assistance. Insure you have read the policy thoroughly, including the insurer's Product Disclosure Statement. Please enter your insurance on your online travel details. Please note, for this trip, your insurance policy should include cruise cover.

MONEY MATTERS

Trip Notes - Greenland Expedition

Your tour cost includes:

- Overnight in the group hotel in Ísafjörður on a twin share basis.
- Transfer to the ship.
- Ten nights on board *M/S Quest* on a twin share basis.
- All meals from dinner on 25 August to breakfast on 5 Sep (excluding lunch on 26 Aug).
- Port taxes and charges imposed by government authorities.
- Zodiac cruises, guided walks and land excursions.
- Educational talks and onboard presentations.
- Bed linen and bath towels.
- Photographic tuition (if the supplement fee has been paid)
- Access to our sea kayaking program (if the supplement has been paid).

Your tour cost does not include:

- Any flights.
- Single room and cabin supplements.
- Travel insurance.
- Tips for the ship's crew (optional, at your discretion).
- Personal expenses such as bar charges and onboard communications.
- Accommodation and meals not listed on the itinerary.
- Passport, visa and departure taxes (if any).

CURRENCY

Iceland's currency is the Icelandic Krone (ISK)- pronounced "krona". 1AUD = 85 ISK and 1USD = 140 ISK (approx). Greenland's currency is the Danish krone (DKK). 1AUD = 4.50DKK and 1USD = 6.80DKK (approx).

The currency on board *M/S Quest* is Norwegian kroner (NOK). On board purchases can be paid with US dollars and Euro, but only in cash and the NOK exchange rate of the day applies. Your ship account will be payable at the end of the expedition by cash or credit card (Visa or MasterCard). The final charges are always in Norwegian kroner (NOK). A tab of your expenses, for example bar purchases or communications, will be kept throughout the expedition. If you share a cabin with someone and prefer separate bills, it is important that you inform the hotel manager directly. We plan to visit Ittoqqortoormiit where there is a chance to buy postcards and stamps from the general store/post office. Payment should be by Danish krone (DKK) although it may be possible to use a credit card.

TIPS/ GRATUITIES

Gratuities for on board staff are optional and at your discretion. For those who wish to express their appreciation for excellent service, you have the option to leave a tip in cash at the end of your trip (NOK/USD/EUR). If needed, it is also possible to tip with your card.

LANGUAGE

Greenlandic is the official language of Greenland, with three main dialects, Kalaallisut (West-Greenlandic), Tunumiit (East-Greenlandic) and Inuktun (North- Greenlandic). The study of Danish and English is mandatory in schools. The official language of Iceland is Icelandic, a North Germanic language similar to Old Norse. The guides and crew on board *M/S Quest* speak English.

VISAS

At the time of writing, there is a planned change to visa requirements in 2025 for citizens from non-EU countries, including Australians, Canadians, New Zealanders and those from the UK and US visiting 30 European countries, including Denmark (which may, as a result, include Greenland) and Iceland. Further information on the ETIAS travel authorisation can be found here: <https://etias.com/> Visas are the responsibility of the traveller.

PASSPORT

Make sure that you have a current passport, with at least two blank pages and a validity extending to six months after the date of your return.

MEDICAL MATTERS

All participants are required to complete an online medical questionnaire filled out completely and accurately prior to the trip. Check with your doctor as to whether you require any vaccinations or boosters. There is a doctor and basic medical supplies on board *M/S Quest*.

MEDICAL SUPPLIES

Basic medical supplies are available on board. However, it's your responsibility to bring sufficient quantities of any specific medications you require. Don't forget your semi-regular medication, for example, asthma inhalers, even if you only occasionally use one. In addition, we suggest that each passenger bring:

- Sunscreen (UV levels in the Arctic can cause sunburn).
- Lip protectant.
- Band-aid strips.
- Insect repellent.
- An anti-nausea drug if you are concerned about sea sickness
- Throat lozenges.
- Liquid handwash.



EQUIPMENT AND CLOTHING

The dress code on board is informal. Please wear sturdy shoes with non-slip soles when moving around the ship. Note, there are no laundry facilities on board *M/S Quest*. A detailed equipment list will be supplied upon booking or on request.

Essential Items:

- Thermal underwear, at least two sets.
- Wool or fleece thermal mid layer, bring a few thin layers instead of thick ones.
- Hiking pants. No cotton.
- Thermal jacket (down or synthetic).
- Waterproof and breathable Gortex (or equivalent) pants and jacket.
- Wool/fleece hat.
- Two pairs of gloves and one pair of mittens
- Three to four pairs of thick wool/synthetic socks and two-three pairs of thinner socks.
- Casual clothes for on board.
- Boat shoes or slippers with rubber soles for below decks.
- Hiking boots for shore excursions.
- Dark sunglasses with a cord to prevent them from falling into the water.
- Sunscreen and sun hat.
- Swimsuit and towel (polar plunge, anyone?).
- Small backpack for day walks (30-40 litres).
- One litre water bottle and/or thermos.
- Camera. Consider a waterproof camera or a small plastic waterproof case or dry-bag with a supply of silicon packs to store your camera when kayaking or on Zodiacs.

Recommended:

- Hiking poles, should be telescopic.

Please feel free to reach out to our team for advice on clothing and equipment selection.

Delays or Problems:

Your guide's contact number and ship contact details will be noted on your final itinerary.

SOUTHERN SEA VENTURES

ssvtrips@southernseaventures.com

www.southernseaventures.com